

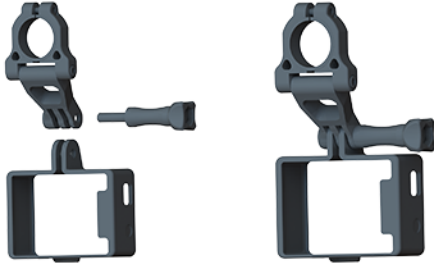

INSTALLATION INSTRUCTIONS FOR Hero, Hero2, Hero3/3+, Hero4, Hero +, Hero4 Session, Hero 5, Hero 5 Session



1 - Install your GoPro camera onto the mount before installing on the rear view mirror. Push the GoPro frame quick release lever and slide the camera into the frame



2 - Lock the frame back in place so the GoPro camera is secure. Make sure if using the Hero 4 Session that the camera is rotated so the power button is on bottom, and the memory card/usb slot is to the right. **IF SHORTER OVERALL MOUNT IS DESIRED, REMOVE CENTER LINK.**

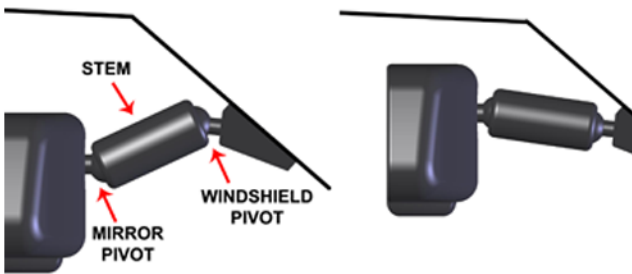

3 - Most compatible mirrors have a stem between the mirror and the windshield that has a pivot on both ends. We recommend that you try moving the mirror upward to minimize any viewing obstruction of the mirror and GoPro camera. Grab the mirror and move the stem upward using the windshield pivot only. Adjust the mirror to your normal viewing position using the mirror pivot only. Notice the higher location of the mirror as shown above.

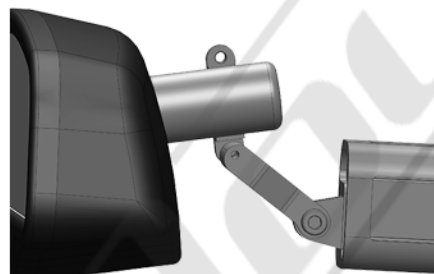

4 - Install this mount from the passenger side of the vehicle. Remove the right half of the mount by removing the two socket head cap screws. Be aware that there is a small lock washer on the lower screw. With the left half of the mount still attached, position the mount around the mirror stem as shown above.

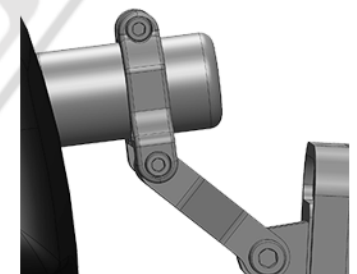

5 - Reattach the right side of the mount. Make sure the small lock washer is still on the lower screw and tighten until the screw is fairly snug. Leave the top screw loose so the mount can slide along the mirror stem to the desired location.



6 - Install the GoPro onto the mount. Make the necessary adjustments as shown in fig. 7. After all adjustments are made, be sure to check that the hinge pivot adjustment screws are tight. The screw on the very top of the mount should be tightened last. Grab the long arm of the allen wrench to assure that these screws are securely tightened. **NOTE: The mirror stem may move side to side while adjusting, make sure the stem points straight ahead so the camera does too.**

BLENDMOUNT ADJUSTMENTS

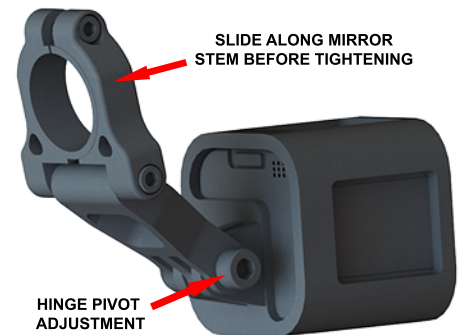

7 - With multiple adjustments available, you should be able to position your GoPro right where you want it. If you are unable to achieve this, be sure to contact us at 1-888-497-8388

CAUTION

DO NOT use this mount if it interferes with the adjustability or the operation of your rear view mirror in any way.

DO NOT use this mount if the GoPro camera creates an unsafe viewing obstruction.

DO NOT ATTEMPT TO MODIFY THIS PRODUCT. Consult the manufacturer for assistance.

All BlendMount products are accompanied with detailed installation instructions and adjustment tips. You are encouraged to contact customerservice@blendmount.com or call J28 Design at 1-888-497-8388 for further assistance.

Check the BlendMount Forum for installation tips and some vehicle specific installs.

www.blendmount.com

Your feedback is very important to us. Please email any questions or comments you have to help@blendmount.com